

PLEASE SPECIFY TOOL MODEL # WHEN ORDERING PARTS

SCHEMATIC	MODEL #	PLD 450.1 B U
PARTS LIST	DESCRIPTION	CORE DRILL MOTOR - 120 V
WIRING DIAGRAM	DATE	6/1/2016

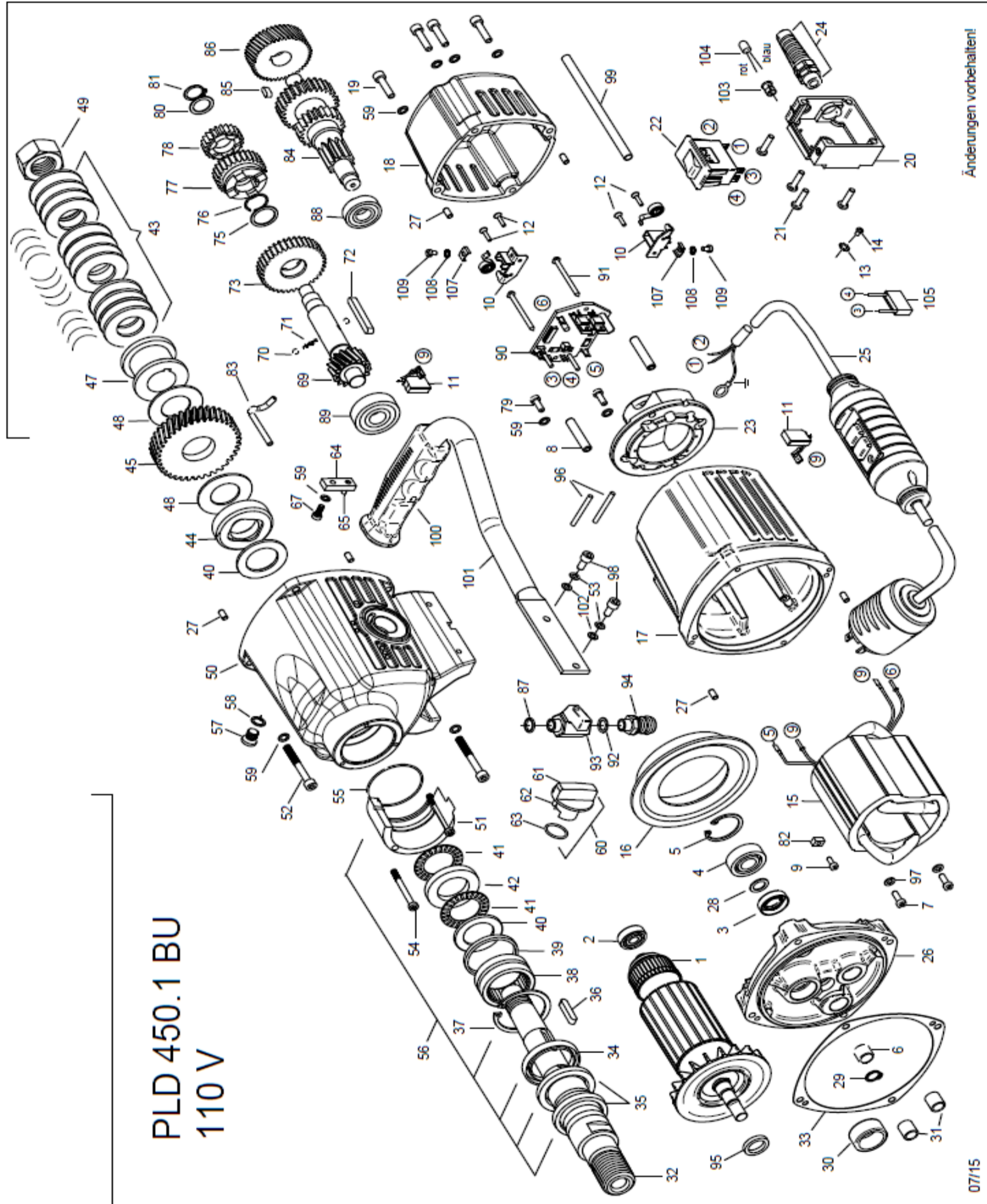



CS Unitec, Inc.  
 22 Harbor Ave  
 Norwalk, CT 06850  
 P: 203.853.9522 F: 203.853.9921

PLEASE SPECIFY TOOL MODEL # WHEN ORDERING PARTS

SCHEMATIC	MODEL #	PLD 450.1 B U
PARTS LIST	DESCRIPTION	CORE DRILL MOTOR - 120 V
WIRING DIAGRAM	DATE	6/1/2016

No.	Description	Order No.	Pcs
1	rotor complete	7373D100	1
2	grooved ball bearing 6201 2RSL	80410103	1
3	shaft seal ring 15x28x7	83000230	1
4	grooved ball bearing 6202 2RS	80410112	1
5	locking ring 35/1,5	80201334	1
6	bearing ring 12x15x12,5	80420160	1
7	screw M5x14	80201103	2
8	bush	73737288	2
9	screw M4x12	80201182	2
10	brush holder	80204514	2
11	carbon brush	80700075	2
12	self tapping screw HC 2,9x9,5	80201251	4
13	tooth lock washer A4,3	80200752	1
14	lens head screw HM 4x10	80201201	1
15	stator complete	7B401554	1
16	air guiding ring	7373C140	1
17	motor housing	73737200	1
18	cap	73737240	1
19	allen screw M6x25	80201125	4
20	switch box	73737630	1
21	screw M5x35	80201137	4
22	switch ETA 20 A	80600119	1
23	brush bridge	73737215	1
24	cable guard M20x1,5	80600179	1
25	connecting cable	7B336262	1
26	end shield of gearing	73737610	1
27	notched pin plug 5x12	80200584	6
28	fitting washer 12/18x1	80200500	1
29	locking ring 12/1	80201321	1
30	needle sleeve HK 2012	80420150	1
31	needle sleeve HK 1212	80420130	2
32	work spindle	73533420	1
33	gearbox seal	82000064	1
34	shaft seal ring 40x52x7	83000073	1
35	shaft seal ring 40x55x7	83000074	2
36	fitting key A6x6x32	80200607	1
37	locking ring J 52	80201392	1
38	needle bearing NK S 37	80420155	1
39	steel ring	73531450	1
40	rotor complete LS 3047	80420165	2
41	axial needle bearing AXK3047A	80420038	2
42	intermediate disc ZS3151	80420168	1
43	spring washer 50x25,4x3	80200717	12
44	supporting disc	73531425	1
45	spindle wheel	73735430	1
46			
47	thrust sleeve	73531423	1
48	braking disk	85000076	2
49	hexagonal nut M24x1,5	73531429	1
50	gearbox housing	73738400	1
51	connecting ring	73733410	1
52	allen screw M6x50	80201471	4
53	lock washer A6	80201303	2
54	allen screw M5x55	80201211	3
55	o-ring 50,52x1,78	83000080	1

No.	Description	Order No.	Pcs
56	connecting ring, premounted	7373341U	1
57	cap screw 1/8"	80201406	1
58	seal ring 1/8"	83000106	1
59	lock washer S6	80201362	11
60	switching complete	73531545	1
61	switch button	73531540	1
62	cylinder pin 4m6x12	80200578	1
63	o-ring 18,77x1,75	83000081	1
64	gear lever	73631542	1
65	cylinder pin 5m6x18	80200619	1
66			
67	screw M5x12	80201230	1
68			
69	pinion shaft	73735490	1
70	ball Ø5	80410081	2
71	compression spring D079	80200694	1
72	fitting key 6x6x50	80200610	1
73	loose wheel	73631460	1
74			
75	fitting washer 20/24,5x1	73531494	1
76	circlip SW 20	80200749	1
77	switch-actuating wheel	73631550	1
78	loose wheel	73631470	1
79	screw M6x14	80201428	2
80	fitting washer 16/22x1	80200514	1
81	locking ring 16/1	80201316	1
82	fitting key	73737205	1
83	oil tube	73631425	1
84	countershaft	73631500	1
85	fitting key 5x5x10	80200600	1
86	intermediate wheel	73735440	1
87	o-ring 12x2,5	83000176	1
88	grooved ball bearing 6001 2Z	80410031	1
89	grooved ball bearing 6302	80410160	1
90	PCB / circuit board	7633B280	1
91	screw 3,9x50	80201416	2
92	seal ring 1/4"	83000107	1
93	mini ball valve	83000143	1
94	connecting piece	83000124	1
95	spacing bush	7373C125	1
96	cord	73737218	2
97	washer A5,3	80201374	2
98	allen screw M6x20	80201124	2
99	isolation hose	73737286	1
100	rubber handle	83000006	1
101	tube handle	73735591	1
102	disc 6,4	80201375	2
103	fastener	73531325	1
104	LED	80601154	1
105	anti parasite condenser	80500010	1
106			
107	contact washer	85000038	2
108	tooth lock washer A4,3	80200752	2
109	screw M4x6	80201154	2