

DESCRIPTION:

Pneumatic Drill

PART NUMBER / DRAWING NUMBER:

2 2502

Page No. : 3/3

Date:09/03

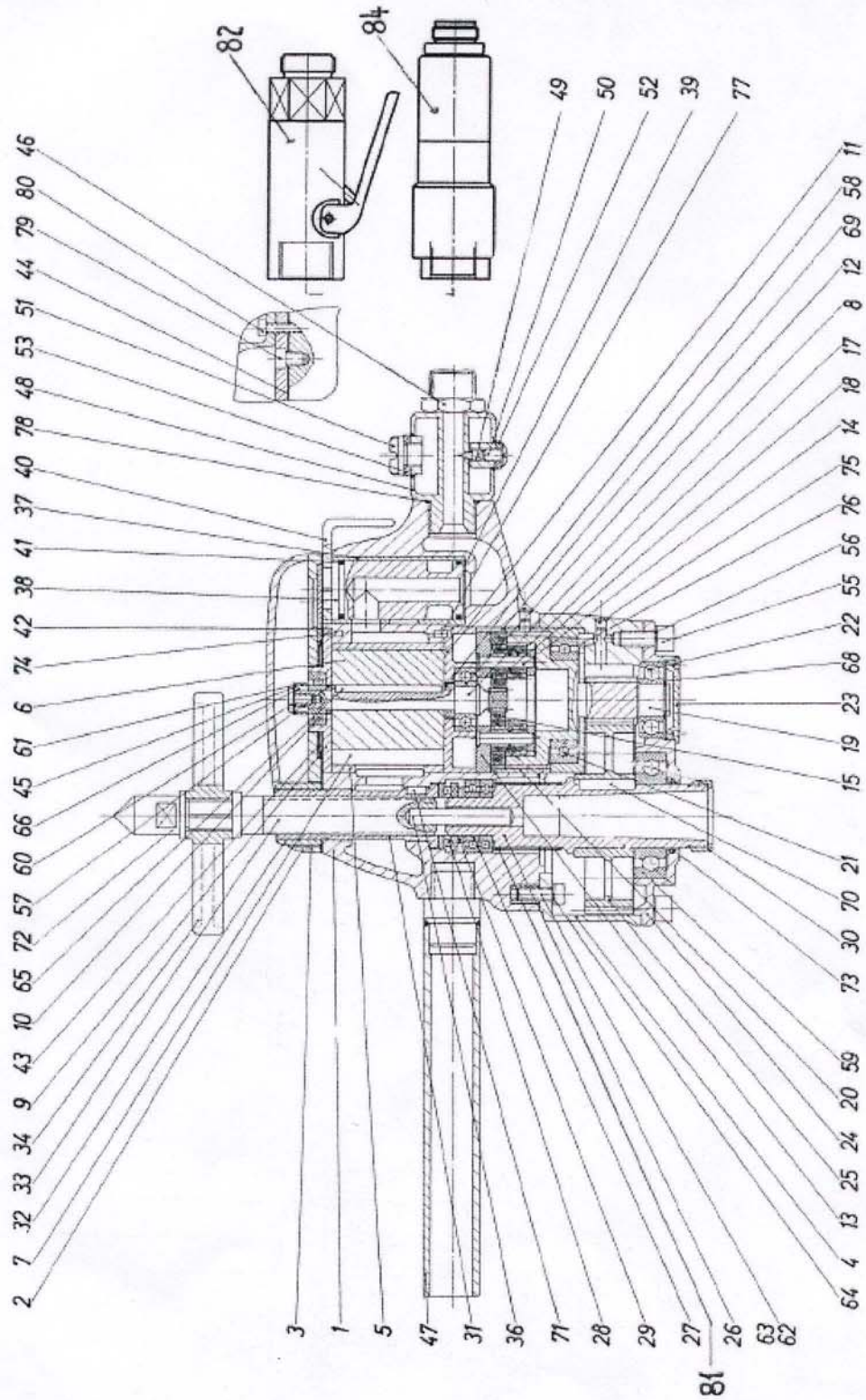

Not responsible for typographical errors.

POS. NO.	ITEM NO.	DESCRIPTION	
	2 2502 1920	Rotor Complete with Pos 6-8	
	9 2401 0080	Oiler Complete	with Pos. 48 - 53
1	2 2502 1910	Motor Housing Assembly	with Pos 5, 37-39, 47, 47
2	2 2502 1120	Frame Cover	
3	2 2502 1130	Intermediate Lid	
4	2 2502 4010	Transmission Cover	
5	2 2502 1020	Cylinder Bushing	
6	2 2502 1030	Rotor	
7	2 2502 1050	Lamelle	
8	2 2502 1930	Rotor Shaft Assembly	with Pos. 65 & 66
9	2 2502 1110	Sealing Plate	
10	9 1004 0020	Bearing	SEE # 107 832
11	2 2502 1100	Plate	
12	9 1004 0330	Bearing	
13	2 2502 4030	Planet Pinion Carrier	
14	2 2502 4050	Planetary Gear Pin	
15	2 2502 4920	Planetary Gear	
17	9 1019 0130	Needle Bearing	
18	2 2502 4080	Intermediate Ring	
19	2 2502 4240	Pinion	
20	2 2502 4060	Bearing Ring	
21	9 1003 0110	Grooved Ball Bearing	
22	9 1004 0050	Bearing	
23	2 2502 4100	Cap	
24	2 2502 4090	Quill	
25	2 2502 4340	Gear Wheel	
26	2 2502 7920	Drilling Case with Pos. 70	
27	9 1002 0040	Grooved Ball Bearing	
28	9 1021 0060	Axial Bearing	

CS Unitec, Inc.

22 Harbor Ave, Norwalk, CT 06850

Telephone: 203-853-9522 Toll Free: 800-700-5919 Fax: 203-853-9921

WebSite: www.csunitec.com E-Mail: info@csunitec.cc

Not responsible for typographical errors.

POS. NO.	ITEM NO.	DESCRIPTION	
29	2 2502 7100	Intermediate Ring	
30	9 1225 0180	Union Nut	
31	2 2502 7910	Feed Case with Pos. 71	
32	9 1223 0270	Nut	
33	2 2502 7930	Feed Chuck with Pos. 36	
34	2 1501 9030	Drehkreuz	
36	9 1637 0170	Pin	
37	2 2502 3310	Socket	
38	2 2502 3320	Reversing Lever	
39	2 2502 3370	Intermediate Washer	
40	2 2012 3360	Reversing Lever	
41	9 1901 4100	O ring	
42	2 2502 1140	Intermediate Washer	
43	9 1801 0010	Spring	
44	2 2502 1150	Seal	
45	2 2502 1160	Spacer Ring	
46	9 1226 0020	Nut	
47	2 2502 6910	Handle	
48	2 1501 5910	Oiler Body	
49	9 1151 9010	Screw	3-13-05-209-00-4
50	9 1150 9020	Filler Plug, Old # 9 1150 9070	3-13-05-208-00-0
51	9 1150 9140	Plug	Replaces 9 1150 9060
52	9 1903 0260	Sealing Ring	3-13-05-210-00-6
53	9 1903 0270	Ring	
55	9 1110 6020	Cheese Head Screw	
56	9 3312 0040	Lock Washer	
57	2 2001 1080	Spacer Ring	
58	2 2502 1080	Spacer Ring	
59	9 1004 0110	Grooved Ball Bearing	

CS Unitec, Inc.

22 Harbor Ave, Norwalk, CT 06850

Telephone: 203-853-9522 Toll Free: 800-700-5919 Fax: 203-853-9921

WebSite: www.csunitec.com E-Mail: info@csunitec.cc

Not responsible for typographical errors.

POS. NO.	ITEM NO.	DESCRIPTION
60	9 1150 9320	Screw
61	9 3311 0010	Lock Plate
62	9 1110 5060	Cheese Head Screw
63	9 1111 5030	Cheese Head Screw
64	9 3312 0030	Washer, spring
65	9 1501 2130	Key
66	9 1506 9350	Key
68	9 1702 0120	USE 80201324
69	9 1506 9040	Key
70	9 1501 5050	Key
71	9 1501 3050	Key
72	2 2502 9040	Feed Screw
73	9 1902 0130	Washer
74	9 1630 0140	Clip Replaces # 9 1626 0070
75	9 3403 0010	Grease Nipple
76	9 1619 0540	Cylinder Pin
77	9 1506 9370	Cotter
78	9 1901 3170	O Ring 3-13-05-206-00-8
79	9 1111 5010	Cheese Head Screw
80	9 1110 4030	Fillister Head Screw SEE#-032.0036 OR 020.0146
81	2 2502 7060	Case for Air Drill 2 2502 0010
84	9 2004 0030	Twist Throttle, Self-Closing

CS Unitec, Inc.

22 Harbor Ave, Norwalk, CT 06850

Telephone: 203-853-9522 Toll Free: 800-700-5919 Fax: 203-853-9921

WebSite: www.csunitec.com E-Mail: info@csunitec.cc