

**PLEASE SPECIFY TOOL MODEL # WHEN ORDERING PARTS**

<b>PARTS BREAKDOWN</b>	<b>Model #:</b> EDS 181	<b>Bulletin #:</b> 05-2017
<b>PARTS LISTING</b>	<b>Description:</b> 7" Stone Saw - Wet/Dry	<b>Prepared By:</b> SCW
<b>WIRING DIAGRAM</b>	<b>Date:</b> 03/24/2017	

### EDS 181 PARTS LIST

Pos. #	Part #	Description	QTY
1	76710100	rotor complete - 110V USA	1
2	76710150	stator complete - 110V USA	1
3	80201234	special screw Meplast 78x3	2
4	80900069	motor housing	1
5	80201199	brush holder	2
6	80201252	self tapping screw HC 2,9x13	4
7	80700040	pair of brushes 6,3x16x20L41F13	2
8	80900073	brush holder cover	2
9	80201270	self tapping screw HC 4,2x13	2
10	80601156	PCB / circuit board - 110V USA	1
11	80201295	plastic nut M5	2
12	80201273	self tapping screw HC 4,2x25	2
13	80201272	self tapping screw HC 4,2x22	1
14	80900400	handle segment	1
15	85000020	wire locking flange	1
16	80201261	self tapping screw HC3,9x13	1
17	83000228	cable grommet - 110V USA	1
18	7660S262	connecting cable 2x1,5mm <sup>2</sup> , 5 m - 110V	1
19	80600506	switch	1
20	80601153	fastener	1
21	80601154	LED	1
22	80201281	self tapping screw HC4,8x25	4
23	7660A400	gearbox housing green	1
24	80200632	countersunk screw M4x10	4
25	80410101	grooved ball bearing 6201 RSZ	1
26	76711110	armature plate	1
27	85000313	bevel pinion	1
28	75412554	bush 1	1
29	80200802	compression spring 0,7x8,5x9x1,5	1
30	75412425	bolt	1
31	75412555	bush 2	1
32	82000511	gearbox seal	1

**PLEASE SPECIFY TOOL MODEL # WHEN ORDERING PARTS**

<b>PARTS BREAKDOWN</b>	Model #: EDS 181	Bulletin #: 05-2017
<b>PARTS LISTING</b>	Description: 7" Stone Saw - Wet/Dry	Prepared By: SCW
<b>WIRING DIAGRAM</b>	Date: 03/24/2017	

### EDS 181 PARTS LIST

Pos. #	Part #	Description	QTY
33	80420116	needle sleeve DL 1012	1
34	80201323	locking ring 17/1	1
35	85000314	bevel gear	1
36	76711425	spacer 2	1
37	80201335	locking ring 42/1,75	1
38	80201271	self tapping screw HC 4,2x16	2
39	7660A420	work spindle	1
40	85000224	cap screw 3/8"	1
41	80201436	pt-screw 50x50	4
42	80900284	air guiding ring	1
43			
44	7660A410	frame	1
45	76711415	spacer 1	1
46	80410051	grooved ball bearing 6004 2RS	2
47	80201415	screw M4x20	1
48	80201269	self tapping screw HC 4,2x9,5	2
49	83000205	shaft seal ring 24x36x7	1
50			
51			
52	7660P94U	slide	1
53	85000243	clamp lever	2
54	80201230	screw M5x12	2
55	80201357	hexagonal nut M5	2
56	80200725	spring washer 12x5,2x0,5	2
57	80200522	fitting washer	2
58	7660P572	suction hood	1
59	76711583	clamp screw	1
60	76721422	pressure washer	1
61	76711580	flange	1
62	80110101	snap bolt	1
63	80430042	face spanner	1
64	80201232	screw M5x40	3



**PLEASE SPECIFY TOOL MODEL # WHEN ORDERING PARTS**

<b>PARTS BREAKDOWN</b>	<b>Model #:</b> EDS 181	<b>Bulletin #:</b> 05-2017
<b>PARTS LISTING</b>	<b>Description:</b> 7" Stone Saw - Wet/Dry	<b>Prepared By:</b> SCW
<b>WIRING DIAGRAM</b>	<b>Date:</b> 03/24/2017	

**EDS 181 PARTS LIST**

Pos. #	Part #	Description	QTY
65	80201376	washer 6,4	1
66	85000236	clamping lever	1
67	80201510	lock washer 10	1
68	85000237	clamp nut	1
69	83000026	o ring 9,5x1,5	1
70	85000238	o ring	1
71	85000235	star handle screw	1
72	80201470	locking pin 6x36	1
73	80901024	support handle	1
74	80201031	square M5	2
75	7660A690	special screw	1
76	7660A952	pressure reducing valve	1
77	83000124	connecting piece	1
78	83000107	seal ring 1/4"	2
79	83000143	mini ball valve	1
80	7660A585	sliding block	1
81	80201407	toggle screw M4x10	1
82	7660A955	water connector	1
83	80201369	washer 4,3	1
84	7660A950	water connector	1
85			
86	85000321	conductor roller	8
87	7660P948	sliding axis	2
88	80201364	lock washer 5	4

EDS 181

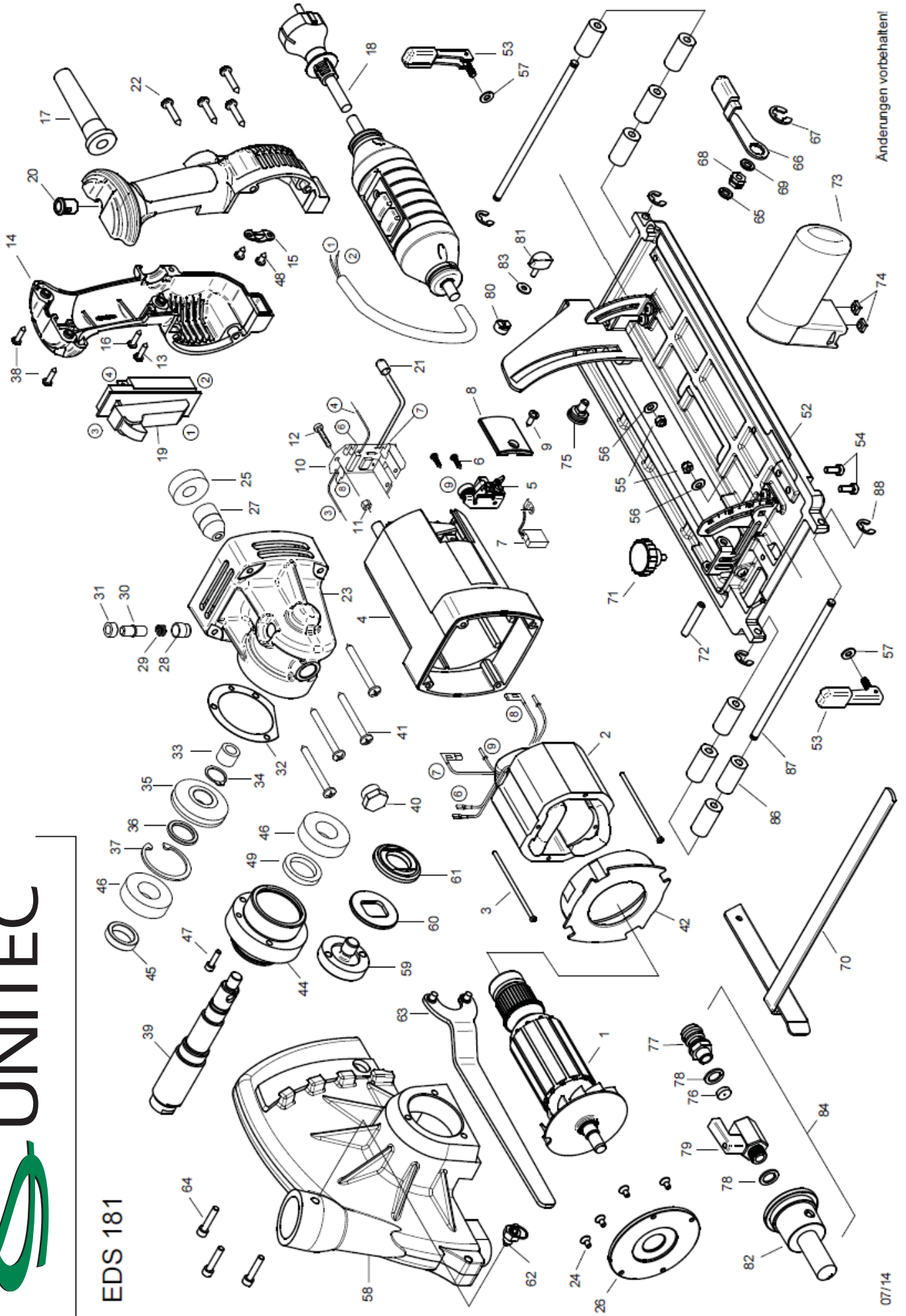

Anderungen vorbehalten!