

OPERATION

Pre-Start Check

Always clear the air hose before connecting it to the Hydrflex, this is to ensure the removal of any foreign bodies that may be present, which would otherwise block, or choke the valve assembly.

Connect a 51mm (2.0") water hose to the rear of the Hydrflex using the hose adapter or fit one of the supplied instantaneous couplings to the hose and connect to the adapter.

IMPORTANT: Take precautions to ensure that the area to be cleaned is completely free of personnel and of any electrical equipment that is exposed or is not protected against water ingress (IP67 minimum protection).

Machine Operation

With one operator securely holding and controlling the Hydrflex a second person should slowly open the water valve at the main or pump.

It is very important that the Hydrflex be held securely while the water is being turned on and while it is in use.

The air valve should now be adjusted carefully to produce a tight hard-hitting jet of water. Excessive air will cause the jet of water to break up and spread, becoming less effective.

In an emergency or once cleaning has been completed, close the air valve and instruct the second operator to shut off the water supply.

Disconnect the air and water hoses and wipe all deposits from the outside of the Hydrflex.

Remove the safety pin and then taking the weight of the Hydrflex, remove the swivel pin from the tripod and remove the Hydrflex. Replace the tripod swivel pin and replace its safety pin.

When collapsing the tripod, take care not to trap fingers or hands. It is recommended that the joints and swivel head of the Tripod be lubricated prior to storage.

Cover the Hydrflex hold cleaner to protect it and store in a secure and dry place.

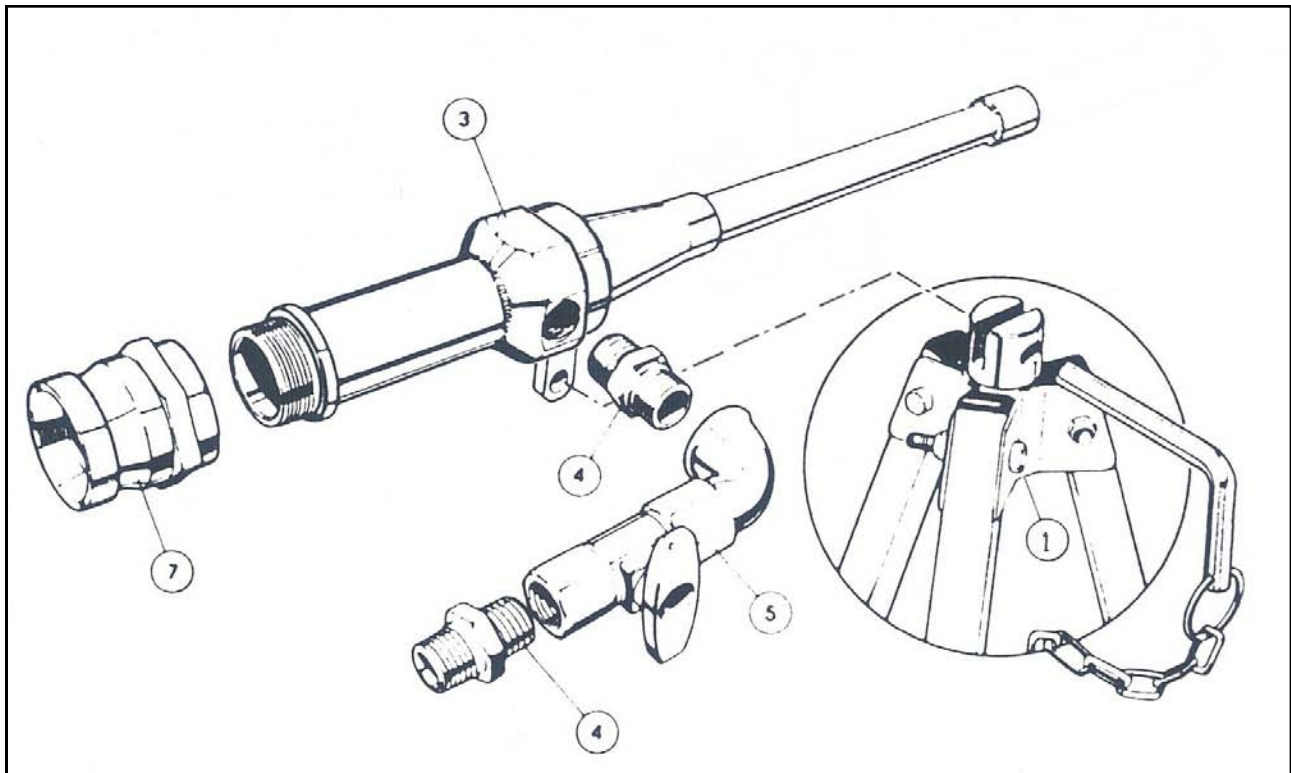

Item No:	Part No:	Description
1	342.HY02	Tripod
3	342.HY35	Main Body
4	342.HY16	Air inlet adapter
5	828.1000	Air inlet control valve
7	342.HY05	Instantaneous water hose adapter
7a	342.HY03	Water hose coupling 2½" x 2½"
7b	342.HY04	Water hose coupling 2½" x 2.0"