

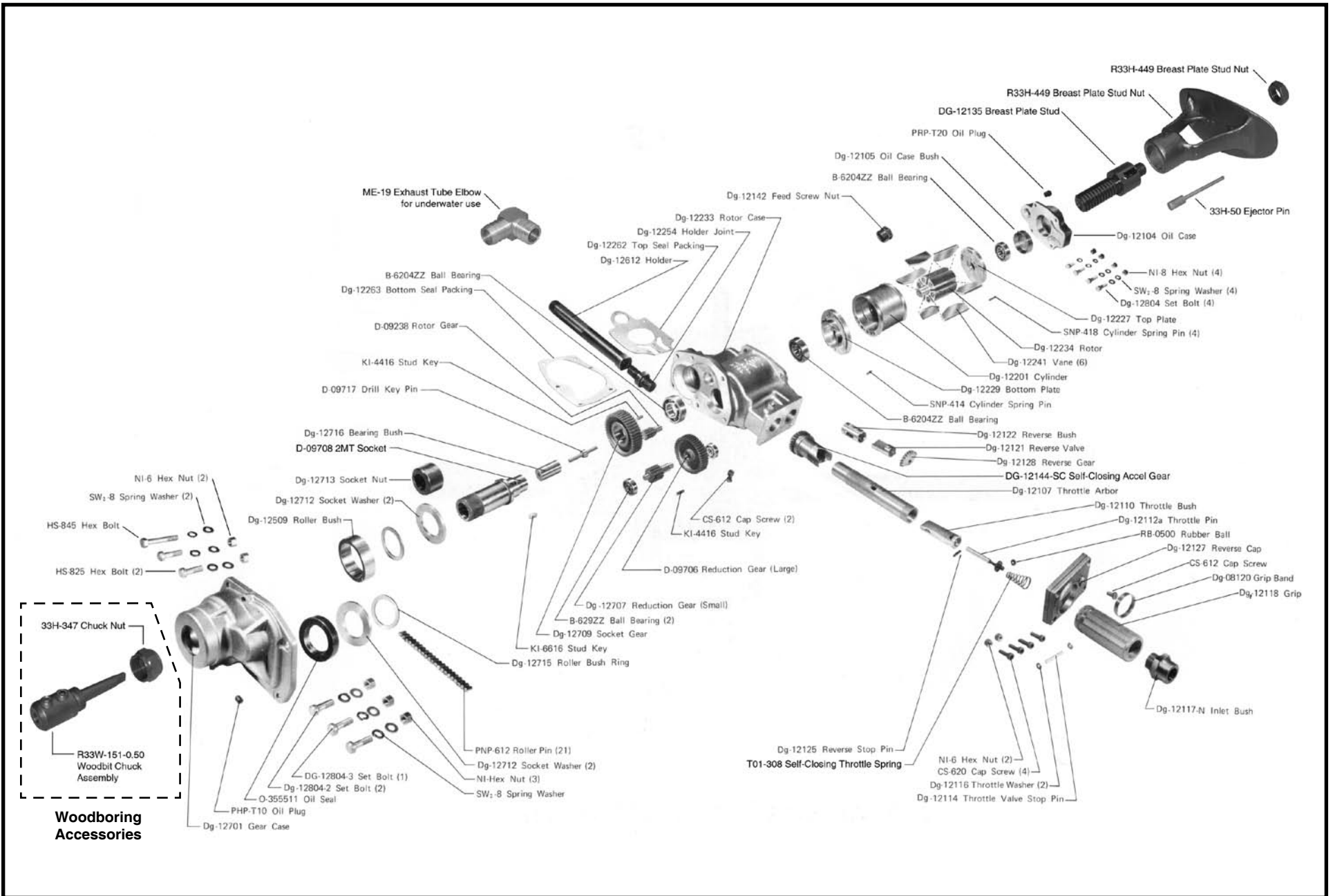

UNITEC

2-1924-0010 2" Reversible Woodboring Drill



Not responsible for typographical errors.

ITEM NO.	DESCRIPTION
33H-347	Chuck Nut
B-6204ZZ	Ball Bearing
B-629ZZ	Ball Bearing (2)
CS-612	Cap Screw (3)
CS-620	Cap Screw (4)
D-09238	Rotor Gar (MP-55R)
D-09706	Reduction Gear (large MP-55R)
D-09708	Socket 2MT
D-09717	Drill Key Pin (MP-55R)
DG-08120	Grip Band
DG-12104	Oil Case
DG-12105	Oil Case Bushing
DG-12107	Throttle Arbor
DG-12110	Throttle Bushing
DG-12112A	Throttle Pin
DG-12114	Throttle Valve Stop Pin
DG-12116	Throttle Washer (2)
DG-12117-N	Inlet Bushing
DG-12118	Grip
DG-12121	Reverse Valve
DG-12122	Reverse Bushing
DG-12125	Reverse Stop Pin
DG-12127	Reverse Cap
DG-12128	Reverse Gear
DG-12135	Breast Plate Stud
DG-12142	Feed Screw Nut
DG-12144	Accel Gear
DG-12201	Cylinder
DG-12227	Top Plate
DG-12229	Bottom Plate
DG-12233	Rotor Case
DG-12234	Rotor
DG-12241	Vane (6 Required)
DG-12254	Holder Joint
DG-12262	Top Seal Packing
DG-12263	Bottom Seal Packing
DG-12509	Roller Bushing
DG-12612	Holder
DG-12701	Gear Case
DG-12707	Reduction Gear (small)
DG-12709	Socket Gear
DG-12712	Socket Washer (2)
DG-12713	Socket Nut

CS Unitec, Inc.

22 Harbor Ave, Norwalk, CT 06850

Telephone: 203-853-9522 Toll Free: 800-700-5919 Fax: 203-853-9921

WebSite: www.csunitec.com E-Mail: info@csunitec.com

Not responsible for typographical errors.

ITEM NO.	DESCRIPTION
DG-12715	Roller Bushing Ring
DG-12716	Bearing Bushing
DG-12717	Drill Key Pin (77R, 66R & 88R)
DG-12804	Set Bolt (4)
DG-12804-2	Set Bolt (2)
DG-12804-3	Set Bolt
HS-825	Hex Bolt (2)
HS-845	Hex Bolt
K1-4416	Stud Key (2)
K1-6616	Stud Key
ME-19	Exhaust Tube Elbow
NI-6	Hex Nut (2)
NI-8	Hexagon Nut (4)
O-355511	Oil Seal
PHP-T10	Oil Plug
PNP-612	Rollin Pin (2)
PRP-T20	Oil Plug
R33H-449	Breast Plate Stud Nut
R33W-151-0.50	Woodbit Chuck Assembly
RB-0500	Rubber Ball
SNP-414	Cylinder Spring Pin
SNP-418	Cylinder Spring Pin (4)
SW2-8	Spring Washer (7)
T01-308	Throttle Spring, self-closing

CS Unitec, Inc.

22 Harbor Ave, Norwalk, CT 06850

Telephone: 203-853-9522 Toll Free: 800-700-5919 Fax: 203-853-9921

WebSite: www.csunitec.com E-Mail: info@csunitec.com